

TRAFFIC MANAGEMENT DURING PIPE LAYING AT JALAN HULU LANGAT - CH 3725 TO CH 3770 - P3 - STAGE 1

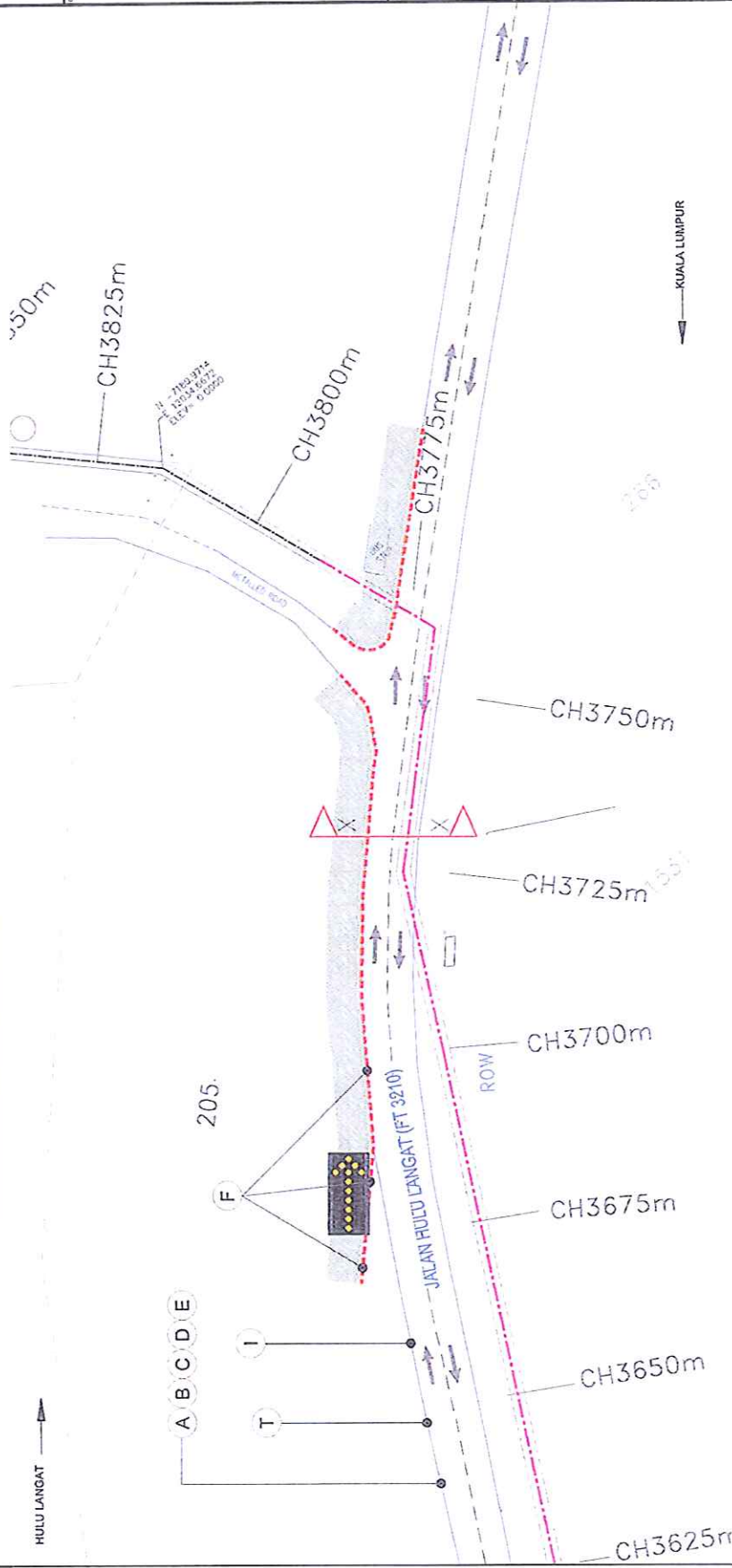

- REMARKS:**
1. BLINKERS : Straight stretch - 30 m interval
Taper - 10 m interval
: With delineator string
 2. SIGNAGES : Fluorescent orange prismatic retro - reflective sheeting
 3. FLAGMAN POSITION INDICATIVE ONLY

LEGEND

	TRAFFIC FLOW		FLAGMAN
	PLASTIC BARRIER		BLINKERS
	WORK AREA		INGRESS/EGRESS
	FLASHING ARROW		SUPER CONE

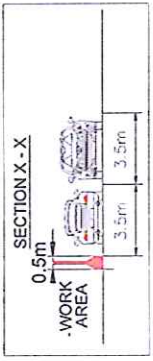
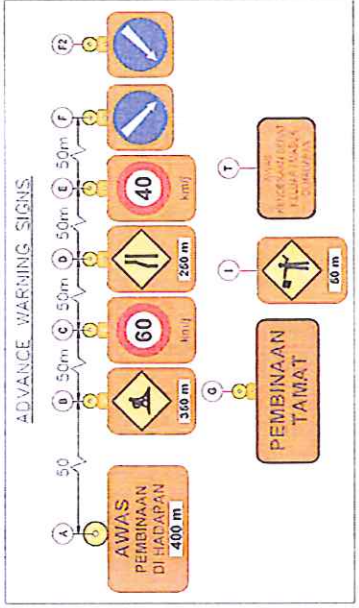

<p>Pengurusan Aset Air Berhad 2, Jalan Selayang Indah, 20000 Kuala Lumpur Tel: 03-26116555 Fax: 03-26116554</p>	<p>SMHB Sdn. Bhd. In Association With rehab consulting sdn bhd CONSULTANT ENGINEER</p>	<p>eda bhd CONSULTING ENGINEER ARCHITECT ENGINEER PROJECT DESIGN OFFICE Langkat 2 WTP and Water Remediation - Phase 1 No. 11, Jalan 1/21 D, Bukit Rendah, 50000 Kuala Lumpur, MALAYSIA TEL: 03-2281 1122 FAX: 03-2281 9938 Email: EDA@eda.com.my Website: www.eda.com.my</p>	<p>PROPOSED DEVELOPMENT OF LANGKAT 2 WATER TREATMENT PLANT AND WATER REMEDIATION PHASE 1 (WATER SUPPLY AND WASTE WATER TREATMENT) AT BUKIT RENDAH, KUALA LUMPUR</p>	<p>JAKS Sdn. Bhd. Lot 526, Kemuning, Subang Heights, 47500 Subang Jaya, Selangor Darul Ehsan, MALAYSIA Tel: 03-4623 1008 Fax: 03-4623 1024 Fax: 03-4623 1008</p>	<p>MAMPU MAMPU BERSAMA SAMA MELAKSANAKAN TRANSFORMASI</p>	<p>MAMPU MAMPU BERSAMA SAMA MELAKSANAKAN TRANSFORMASI</p>	<p>TRAFFIC MANAGEMENT DURING PIPE LAYING AT JALAN HULU LANGAT - CH 3725 TO CH 3770 - P3 - STAGE 1</p>	<table border="1"> <tr> <td>REVISION</td> <td>DATE</td> <td>BY</td> <td>CHKD</td> </tr> <tr> <td> </td> <td> </td> <td> </td> <td> </td> </tr> <tr> <td> </td> <td> </td> <td> </td> <td> </td> </tr> <tr> <td> </td> <td> </td> <td> </td> <td> </td> </tr> </table>	REVISION	DATE	BY	CHKD													<p>NO. 15748/2016 R. GUNASEGARAN 15/07/2016</p>	<p>NO. 15748/2016 R. GUNASEGARAN 15/07/2016</p>	<p>NO. 15748/2016 R. GUNASEGARAN 15/07/2016</p>
REVISION	DATE	BY	CHKD																								

TRAFFIC MANAGEMENT DURING PIPE LAYING AT JALAN HULU LANGAT - CH 3725 TO CH 3770 - P3 - STAGE 2

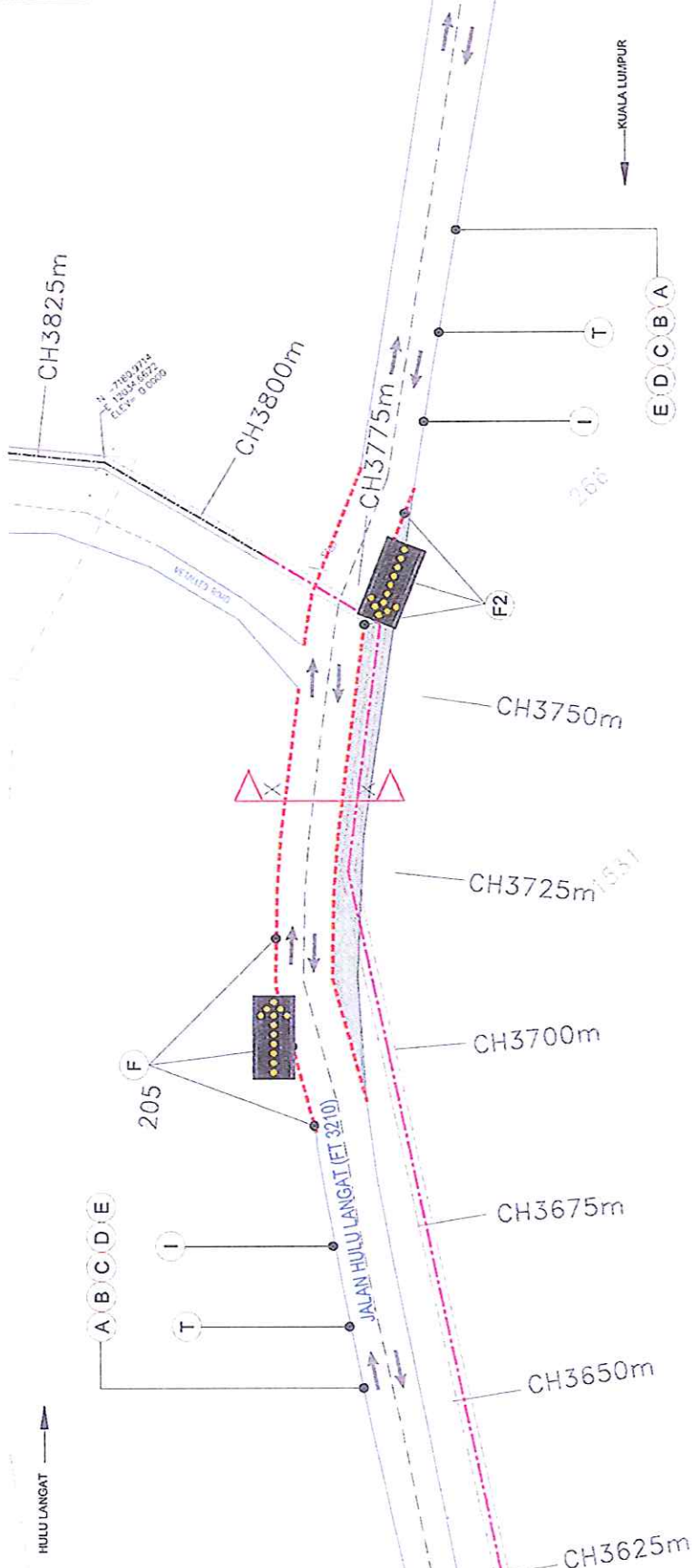

- REMARKS:**
1. BLINKERS : Straight stretch - 30 m interval
Taper - 10 m interval
: With delineator string
 2. SIGNAGES : Fluorescent orange prismatic retro - reflective sheeting
 3. FLAGMAN POSITION INDICATIVE ONLY

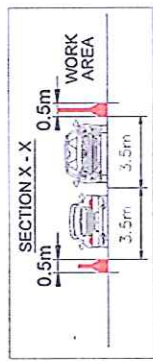
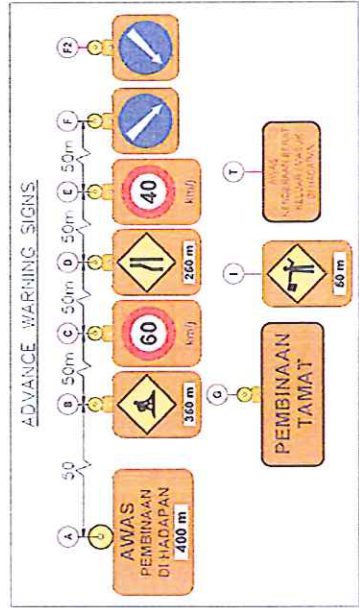
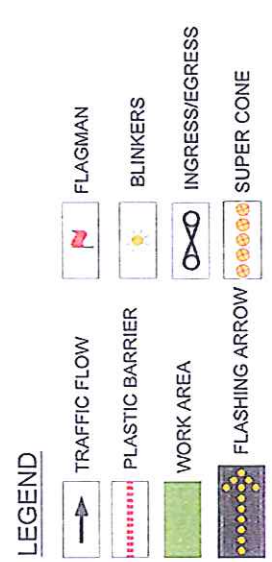

<p>CLIENT</p> <p>Pengurusan Asest Air Berhad Tingkat 24, Menara Mulu Perpus, Crystal Square No. 10, Jalan Sultan Ismail, Kuala Lumpur Tel: 03-2044555 Fax: 03-2044558</p>	<p>CONSULTANT</p> <p>SMHB Sdn. Bhd. Specialist Engineering Services Sdn. Bhd. In Association With renhilt consulting sdn bhd consultant Partner</p>	<p>PROJECT DESIGN OFFICE</p> <p>Langkat 2 WTP and Water Retention - Phase 1 No. 3, Jalan T. 25 D, Desa Padas, Mukoh, 43000 Kajang, Selangor Darul Ehsan, Tel: 03-89281122 Fax: 03-89281018 Email: ERM@renhilt.com Website: www.renhilt.com</p>	<p>PROPOSED DEVELOPMENT OF LANGAT 2 WATER TREATMENT PLANT AND WATER RETICULATION SYSTEM IN SELANGOR DARUL EHSAN / WILAYAH PERSEKUTUAN KUALA LUMPUR</p>	<p>MANAGER/CLIENT</p> <p>JAKS Sdn. Bhd. Lot 536, Kawasan Skudai Komersial, Kawasan Perindustrian Skudai, 81300 Skudai, Johor Darul Ehsan, Johor Darul Ehsan, Tel: 03-803 898 00 - 803 895 804 Fax: 03-803 208 208</p>	<p>MANAGER/CLIENT</p> <p>MUHIBAH KONSORTIUM HOLDINGS SDA DHD 9-2, JALAN PUNYAT PERJAGAAN 2, PUSAT PERJAGAAN SOJELOK, 43000 KAJANG, SELANGOR DARUL EHSAN, TEL: 03-87245372 FAX: 03-87293372</p>	<p>PROJECT TITLE</p> <p>Membekal Dan Memasang Pap Air Terawal Ulana Dari Kolam Air Imbingan Bukit Enggang Ke Kolam Air Langkat Sungai Dan Pap Air Langkat 2 WTP dan Water Retention - Phase 2 Ke Kolam Air Imbingan Hulu Langat.</p>	<p>DATE OF ISSUE</p> <p>17/11/2018</p>	<p>SCALE</p> <p>1:1</p>	<p>PROJECT NO.</p> <p>PAAB-LPS-JARIG-SEP-15-1701-002</p>	<p>REV.</p> <p>01</p>	<p>DATE</p> <p>17/11/2018</p>	<p>BY</p> <p>A</p>	<p>CHKD.</p> <p>02</p>
--	--	---	---	---	---	---	---	--------------------------------	---	------------------------------	--------------------------------------	---------------------------	-------------------------------

TRAFFIC MANAGEMENT DURING PIPE LAYING AT JALAN HULU LANGAT - CH 3725 TO CH 3770 - P3 - STAGE 3

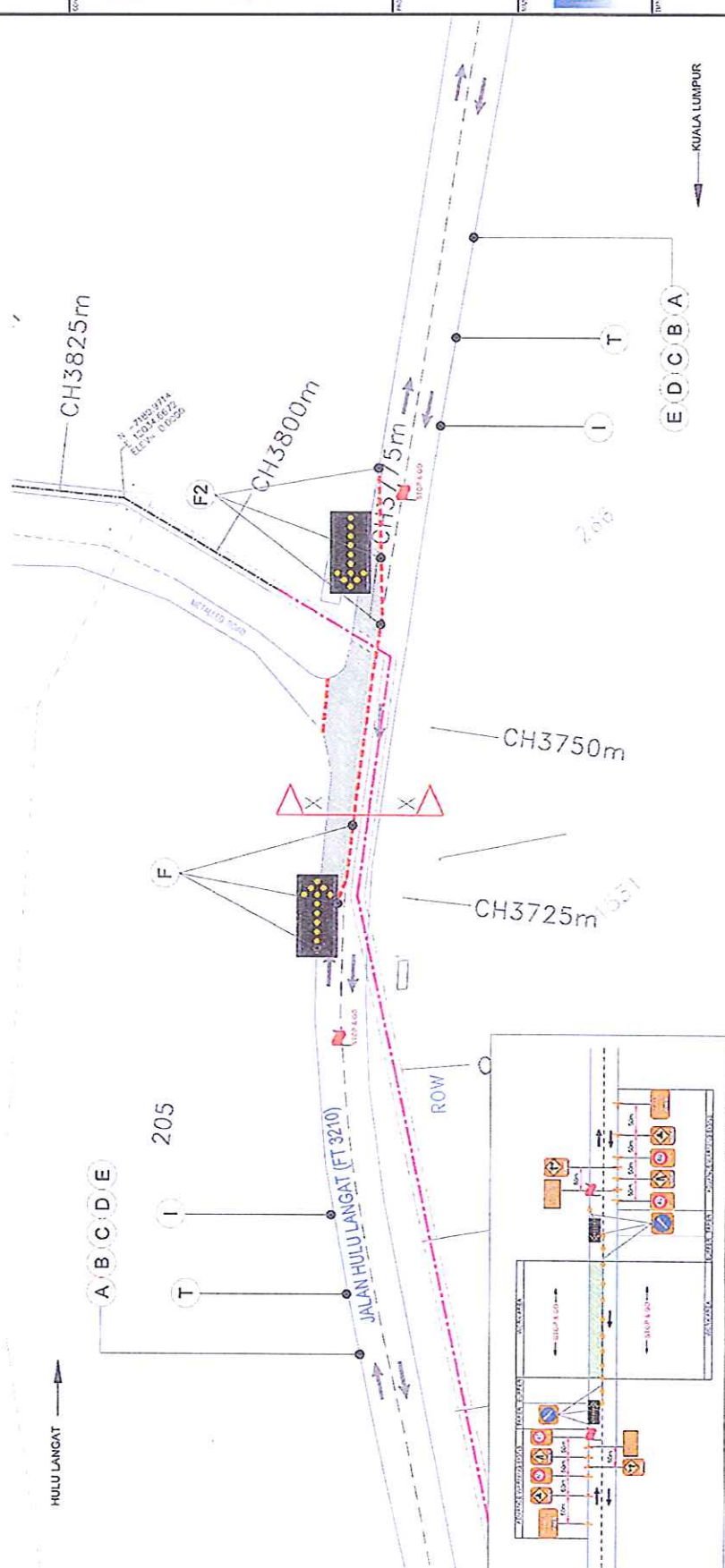

- REMARKS :**
- BLINKERS : Straight stretch - 30 m interval
Taper - 10 m interval
: With delineator string
 - SIGNAGES : Fluorescent orange prismatic retro - reflective sheeting
 - FLAGMAN POSITION INDICATIVE ONLY

LEGEND

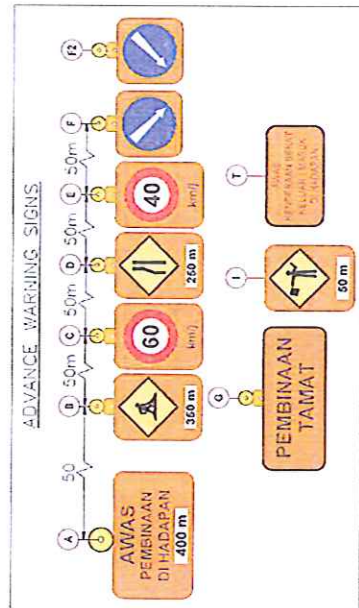

<p>CLIENT</p> <p>Perkhidmatan Aset Air Berhad No. 1, Jalan Sungai Air Panas, Empress Valley, Kuala Lumpur. Tel: (603) 24141001 Fax: (603) 24141006</p>	<p>CONSULTANT</p> <p>SMHB Sdn. Bhd. Jalan Puchong, Puchong, Selangor</p> <p>In Association With</p> <p>ronhill consulting sdn bhd CONSULTANT ENGINEER</p> <p>ETA Tenaga sdn bhd CONSULTANT ENGINEER AMPLIFIER ENGINEERING</p>	<p>PROJECT DESIGN OFFICE Langkat 2 WTP and Water Retention - Phase 1</p> <p>No. 10, Jalan 17/3A, Duta Kincah, Wangsa Maju, Kuala Lumpur, Malaysia Tel: (60) - 3261 1122 Fax: (60) - 3261 1122 Email: E.MAL@langkat2.com Website: www.langkat2.com</p>	<p>PROJECT TITLE</p> <p>PROPOSED DEVELOPMENT OF LANGKAT 2 WATER TREATMENT PLANT AND WATER RETENTION TANKS AT JALAN HULU LANGAT, DARUL EHSAN, WILAYAH PERSEKUTUAN KUALA LUMPUR</p>	<p>DESIGNER</p> <p>JAKS Sdn. Bhd. No. 50, Jalan Puchong, Puchong, Selangor No. 42, Jalan Puchong, Puchong, Selangor 42000 Puchong, Selangor Darul Ehsan Tel: (60) - 3263 2888 No. 4232 8284 Fax: (60) - 3263 2888</p>	<p>APPROVED BY</p> <p>MUMBAH KONDORTUHI HOLDINGS SDN BHD 92, JALAN PUSAT PERMAGAN 2, PUSAT PERMAGAN 20 JEJOK, 43000 KUALANG, BELANGOR DARUL EHSAN, TEL: (03) 37345372 FAX: 03-87935372</p>	<p>APPROVED BY</p> <p>Menteri dan Timbalan Pagar Air, Terowak Kuala Lumpur Ke Kelah Air Langat Bekas dan Pagar Air, Terowak Uluksu dan Loh Rawan Air, Langkat 2 Ke Kelah Air Ibbangan Hulu Langat.</p>	<p>PROJECT NO. TRAFFIC MANAGEMENT DURING PIPE LAYING AT JALAN HULU LANGAT - CUI 3725 TO CH 3770 - P3 - STAGE 3</p> <table border="1"> <tr> <td>DATE</td> <td>REVISION</td> </tr> <tr> <td>DATE</td> <td>REVISION</td> </tr> <tr> <td>DATE</td> <td>REVISION</td> </tr> </table> <p>SCALE: 1:1000</p> <p>PROJECT NO: 3725 TO CH 3770 - P3 - STAGE 3</p>	DATE	REVISION	DATE	REVISION	DATE	REVISION
DATE	REVISION												
DATE	REVISION												
DATE	REVISION												